

1	Batten and tiles / slates (by specialist subcontractor)
2	Sarking felt (by specialist subcontractor)
3	Tilting fillet / mechanical fixing (by specialist subcontractor)
4	Plywood layer board (by specialist subcontractor)
5	FM/D contact adhesive
6	Restaint bar, cord and mechanical (MTP) fixing
7	ECOLINE® FM single ply membrane single ply membrane fully bonded using ADH adhesive
8	Heat welded seam - 40mm
9	ECOLINE® ADH fleeceback single ply membrane fully bonded using ADH adhesive
10	HYTHERM® tapered / flat board insulation fully bonded using Hyra-Stik adhesive (thickness to achieve design U-value and/or design fall)
11	Vernis Antac ST primer
12	ECOLINE® air & vapour control layer (AVCL)
13	Plywood roof deck by specialist contractor
14	ECO/200 separation membrane (taped)
15	ADH Adhesive

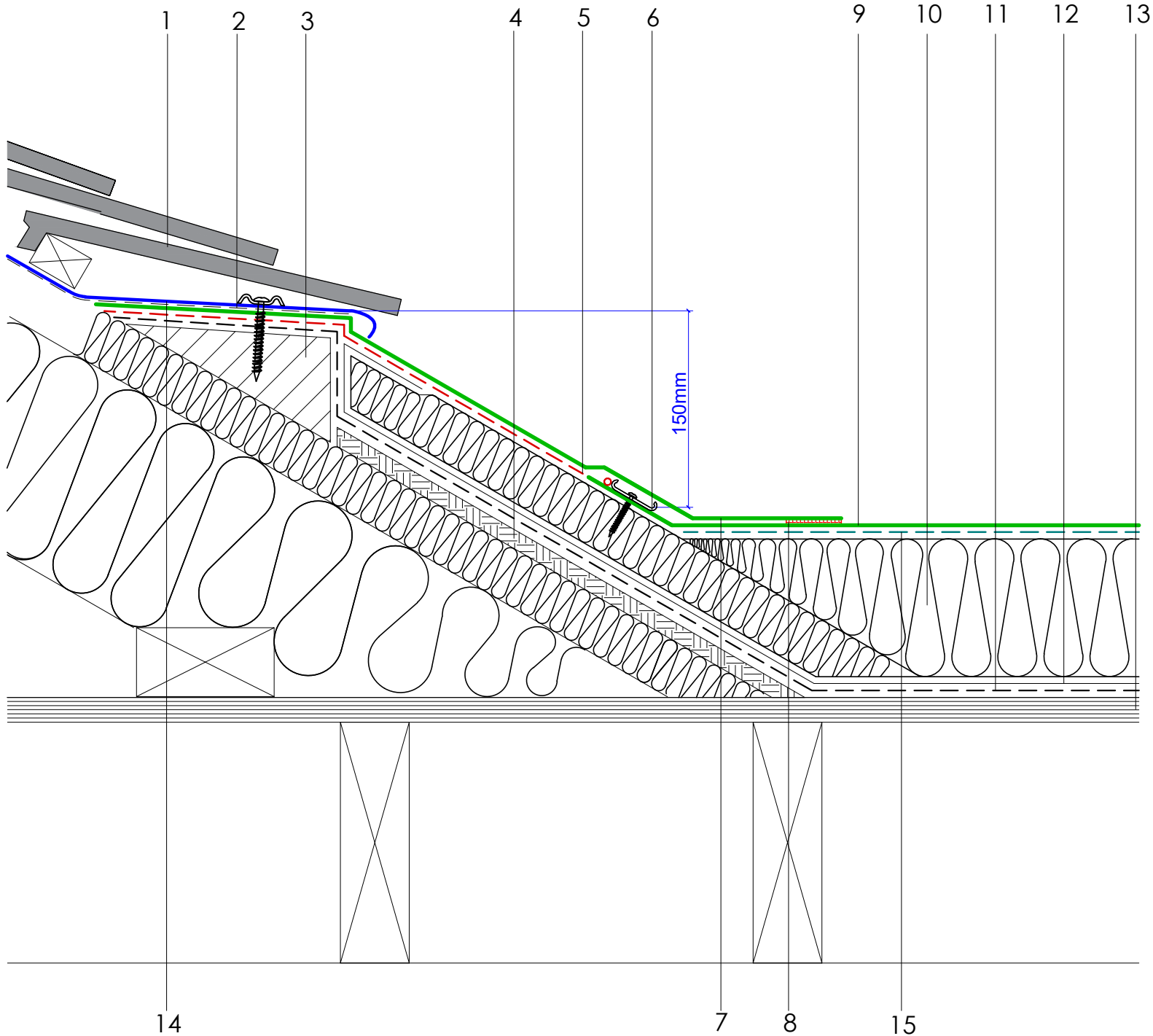

Axter provide detail drawings as part of our technical design service. Such drawings should only be used as a guide during the design process and should not be utilised during construction. Axter accepts no liability for misuse of this service.

PROJECT : N/A
CLIENT : N/A
DRAWING : ECOLINE® ADH TYPICAL PITCHED TO FLAT ROOF ABUTMENT DETAIL (INSULATED)

DWG.No
WR.P.EL.adh.120

SCALE
1:5 @ A4

DATE
2019

REV (if applicable)
N/A

STANDARD DETAIL