



FORCE® LINE
high performance SBS waterproofing

FORCE[®] LINE

High performance SBS waterproofing



PROFESSIONAL roofing contractors demand professional materials from specialist manufacturers. At Axter, we offer a modern and forward-thinking approach to flat roof waterproofing. We aim to revolutionise the way flat roofs are designed, installed, used, and maintained.

Your choice of supplier impacts the success and reputation of your business. When it comes to flat roofing solutions, Axter stands out as a trusted partner renowned for its commitment to excellence, innovation, and sustainability.

We're on a mission to elevate flat roofing as a commercial product offering, ensuring professional roofing contractors – whether tackling minor roofing jobs or working on larger-scale endeavours – have access to high-quality materials and systems, along with the technical guidance needed to ensure successful project delivery.



BENEFITS

like high strength and durability make the FORCE® LINE system range a popular choice for professional roofers. Five key reasons to partner with Axter:

- **Exceptional product quality and choice.** Axter's Force Line range of products are available for pick-up by customers at our merchants stockists.
- **Access to technical expertise and support.** Axter provides a robust support network for all its stockists and accredited contractors, ensuring they have access to our extensive technical expertise, assistance, and bespoke design offering.
- **Innovative solutions to sustainability.** Partnering with Axter allows you to align with the growing demand for sustainable construction practices.
- **Product warranties.** Grant customers peace of mind. See page 29 for more details.
- **A trusted name.** From superior product quality to diverse offerings, partnering with Axter offers numerous benefits that can drive growth, profitability, and customer satisfaction.



FIRE CERTIFICATION & PERFORMANCE

is critically important when designing and constructing all buildings. The fire resistance of the flat roof covering, in terms of penetration and spread of flame from the outside of the building, is crucial.

The Axter Force Line System assemblies are:

- Certified BROOF(t4) - in accordance with BS EN 13501-5 to cover a range of thicknesses
- Reaction to fire tested membranes and insulation- in accordance with BS EN 13501-1

If you have any questions about regulatory guidance, contact our Technical Support team here: <https://axter.co.uk/contact>



EACH SYSTEM undergoes rigorous testing to ensure durability and performance. We're happy to work with you to specify and supply our Green Roof, Blue Roof and Solar PV systems.

At Axter Ltd, we imagine a world where the roof is used to its full potential, protecting what's inside the building and also benefitting the climate and communities that surround it.

To achieve this, we are always innovating. We are proud to combine this drive for creativity with market-leading expertise. For more information on these systems, get in touch with us here:

01473 724056

info@axterltd.co.uk



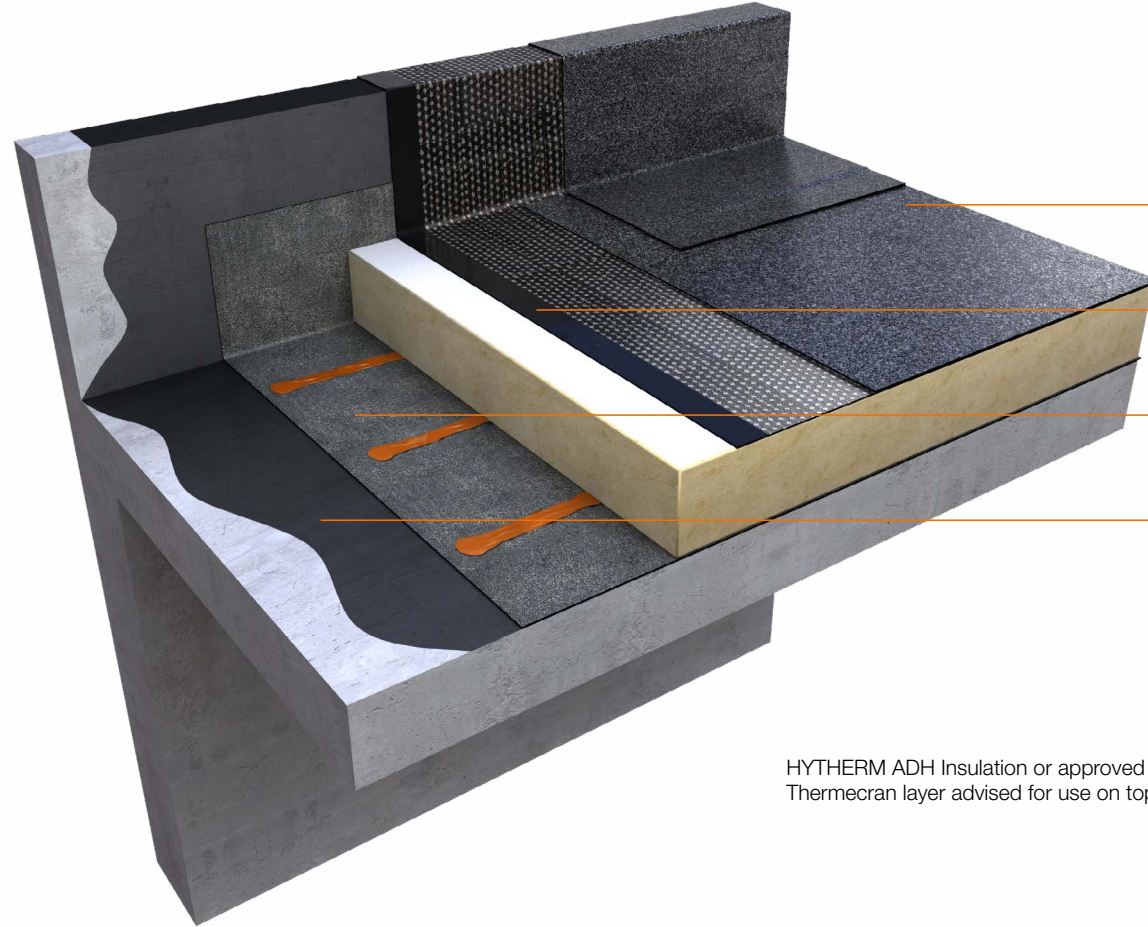

HYTHERM ADH Insulation or approved Axter equivalent to be used.
Thermecran layer advised for use on top of the insulation

FORCE® LINE SBS

High performance SBS **multi-layer** waterproofing system

FORCE LINE SBS

FORCE LINE 2VV

FORCE LINE 2S **or** FORCE LINE 2VV

BITUMEN BASED PRIMER

A cost effective multi-layer build up, FORCE® LINE SBS provides secure waterproofing, ideal for buildings where a 10 year material warranty is sufficient.

10 YEAR
WARRANTY



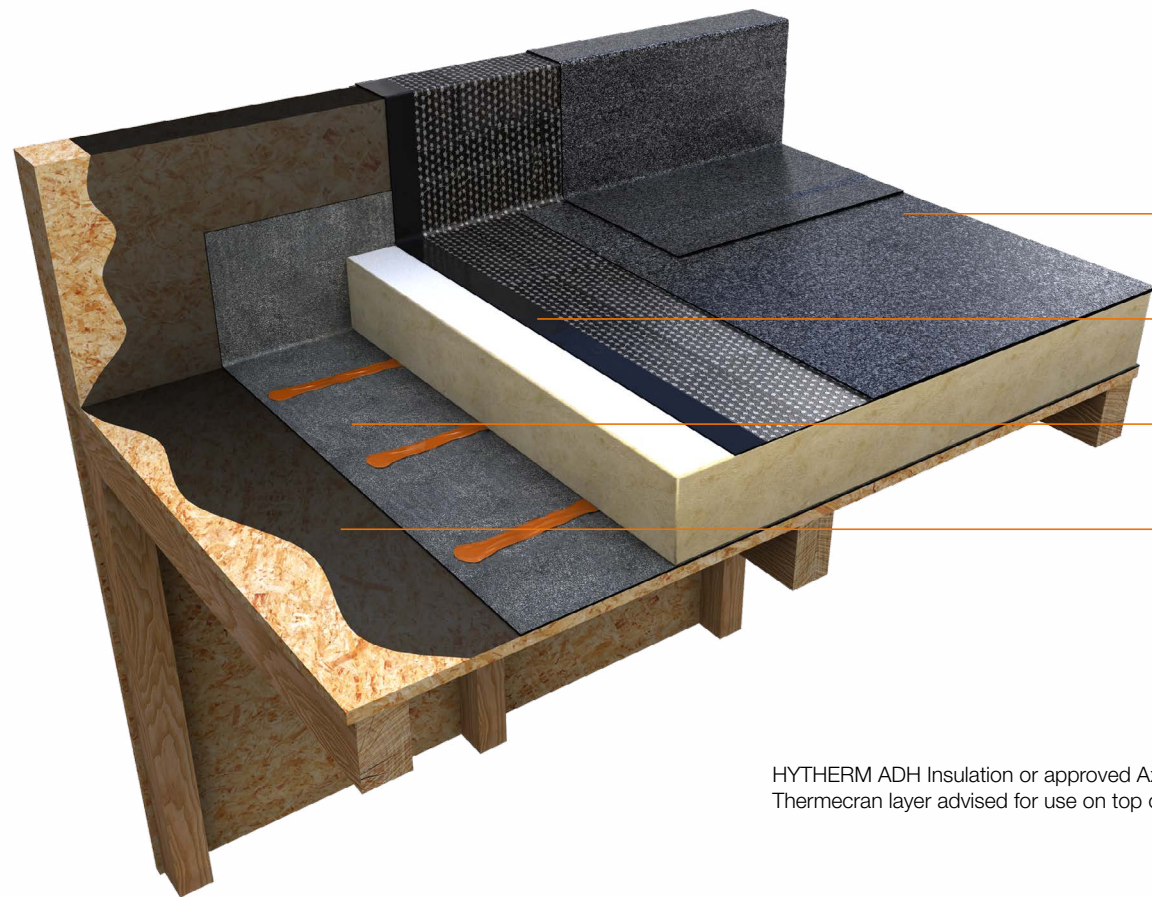

HYTHERM ADH Insulation or approved Xter equivalent to be used.
Thermecran layer advised for use on top of the insulation

FORCE® LINE 4.0

High performance SBS **multi-layer** waterproofing system

FORCE LINE 4.0

FORCE LINE 2VV

FORCE LINE 2S **or** FORCE LINE 2VV

BITUMEN BASED PRIMER

Increased material thickness and enhanced durability, the FORCE® LINE 4.0 capsheet provides a hard wearing finish to a multi-layer build up and achieves a 15 year material system warranty.

15 YEAR
WARRANTY



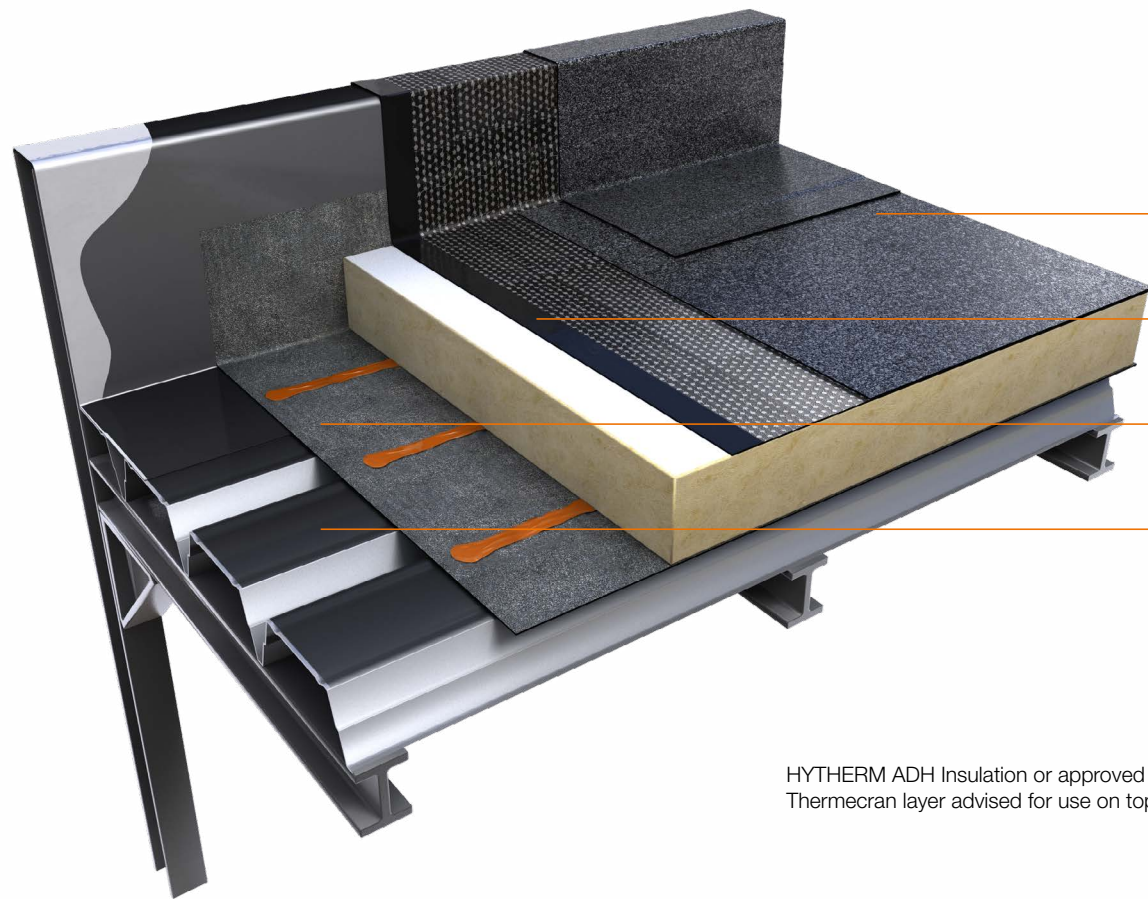

HYTHERM ADH Insulation or approved Axter equivalent to be used.
Thermecran layer advised for use on top of the insulation

FORCE® LINE 4.5

High performance SBS **multi-layer** waterproofing system

FORCE LINE 4.5

FORCE LINE 2VV

FORCE LINE 2S **or** FORCE LINE 2VV

BITUMEN BASED PRIMER

FORCE® LINE 4.5 is a durable and high-performance capsheet within the multi-layer waterproofing range, providing a 20-year material system warranty as standard.

20 YEAR
WARRANTY



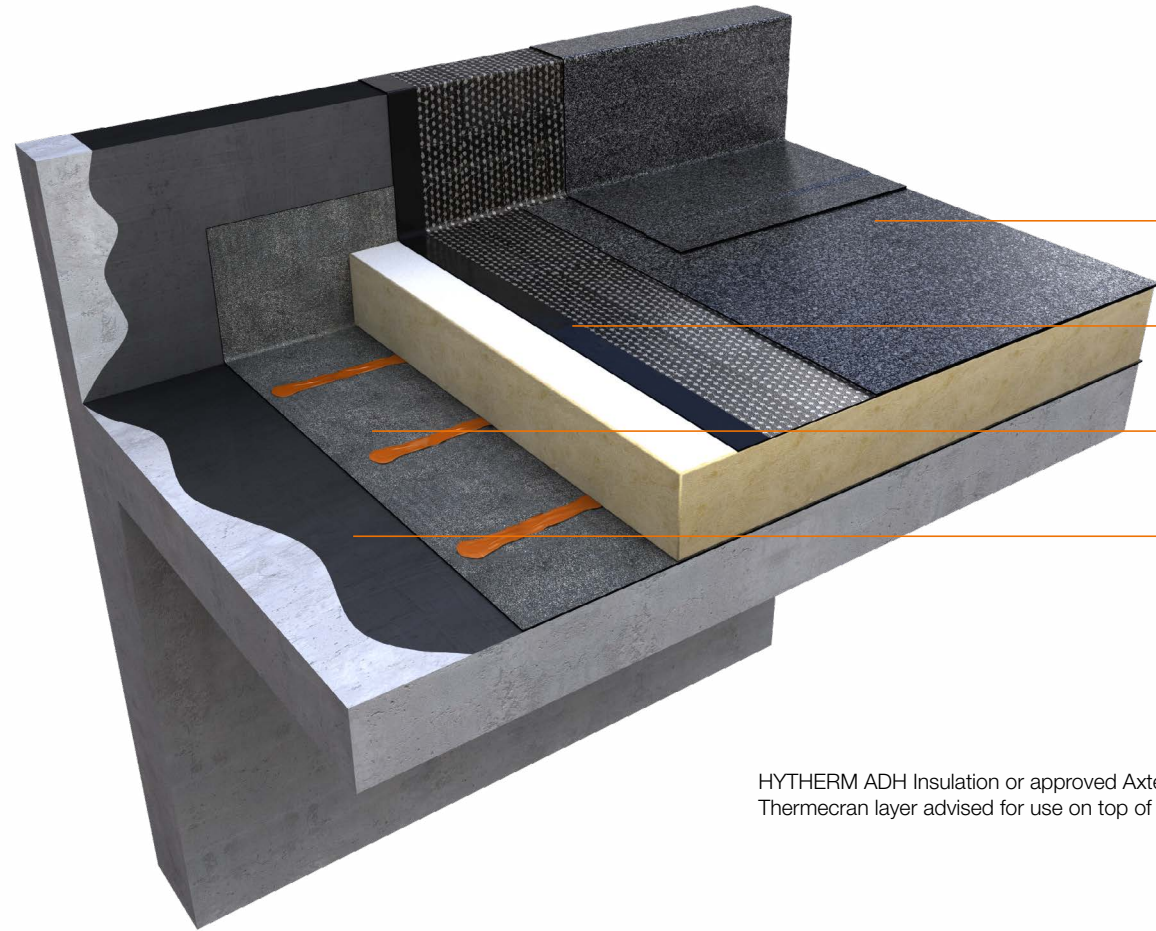

HYTHERM ADH Insulation or approved Axter equivalent to be used.
Thermecran layer advised for use on top of the insulation

FORCE® LINE 4.5

High performance SBS **multi-layer** waterproofing system

FORCE LINE 4.5

FORCE LINE 3VV

FORCE LINE 3VV

BITUMEN BASED PRIMER

When combined with FORCE® LINE 3VV underlayer and AVCL as part of a multi-layer build up FORCE® LINE 4.5 achieves a 25 year material system warranty.

25 YEAR
WARRANTY



SINGLE LAYER

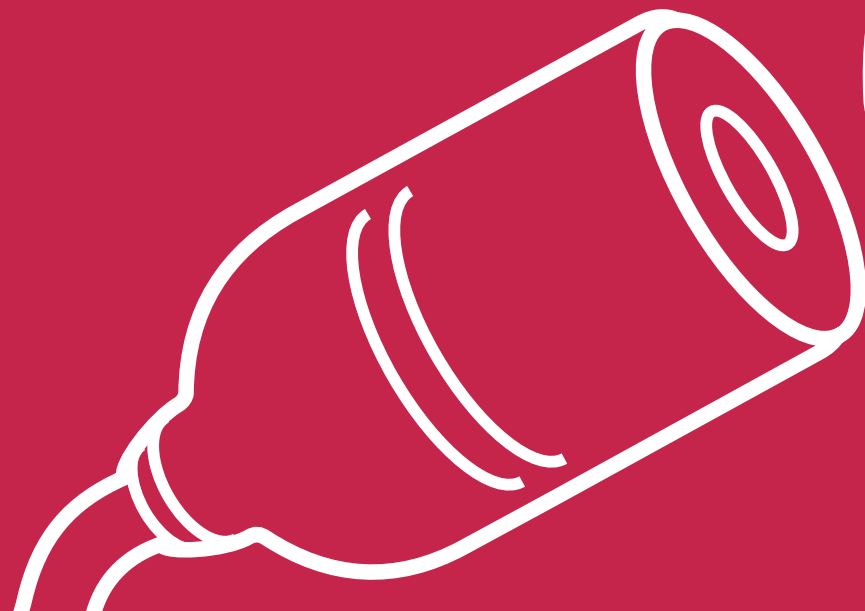

FORCE® SOLO

Manufactured with Axter's unique ALPA® mix binder, BBA Approved FORCE® SOLO roof waterproofing overlay membranes provide significantly improved ageing characteristics and durability performances over standard SBS bitumen membranes.

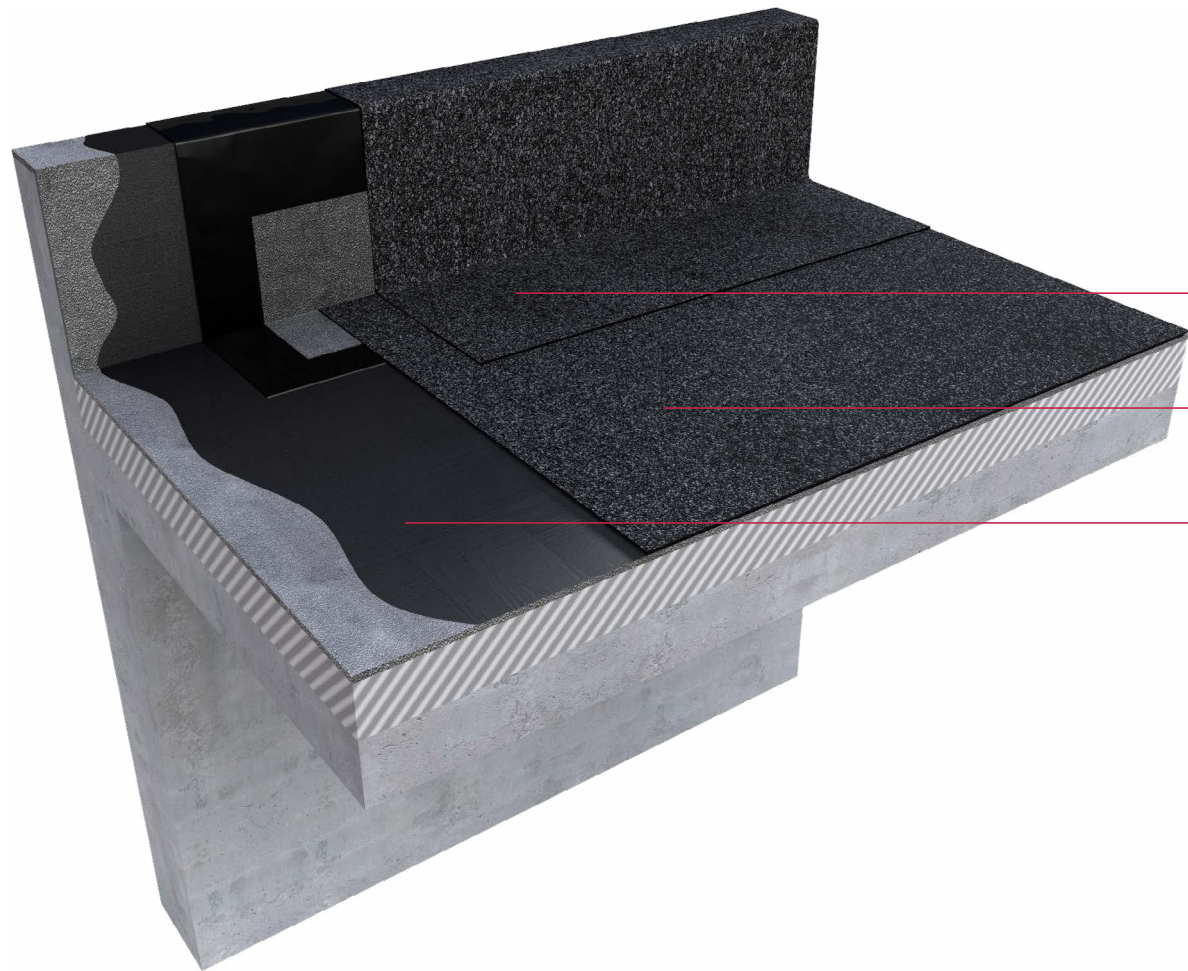

FORCE® SOLO

High performance ALPA® SBS **single-layer** overlay system

FORCE LINE 3VV + FORCE LINE SOLO

FORCE LINE SOLO

BITUMEN BASED PRIMER



A highly robust BBA approved single layer overlay membrane with ALPA® mix binder providing extended life expectancy, Achieving a 30 year material warranty with Force SA and a 25 year warranty as standard.

25 YEAR
WARRANTY



GREEN ROOF



FORCE® 4000 TRAFIC

FORCE® 4000 TRAFIC waterproofing systems are perfectly adapted to the needs of green roofs with significant resistance to impact, roots, fertilisers and insecticides. FORCE® 4000 TRAFIC systems are BBA certified, conform to all standards and can be used under all forms of intensive and extensive green roof systems.

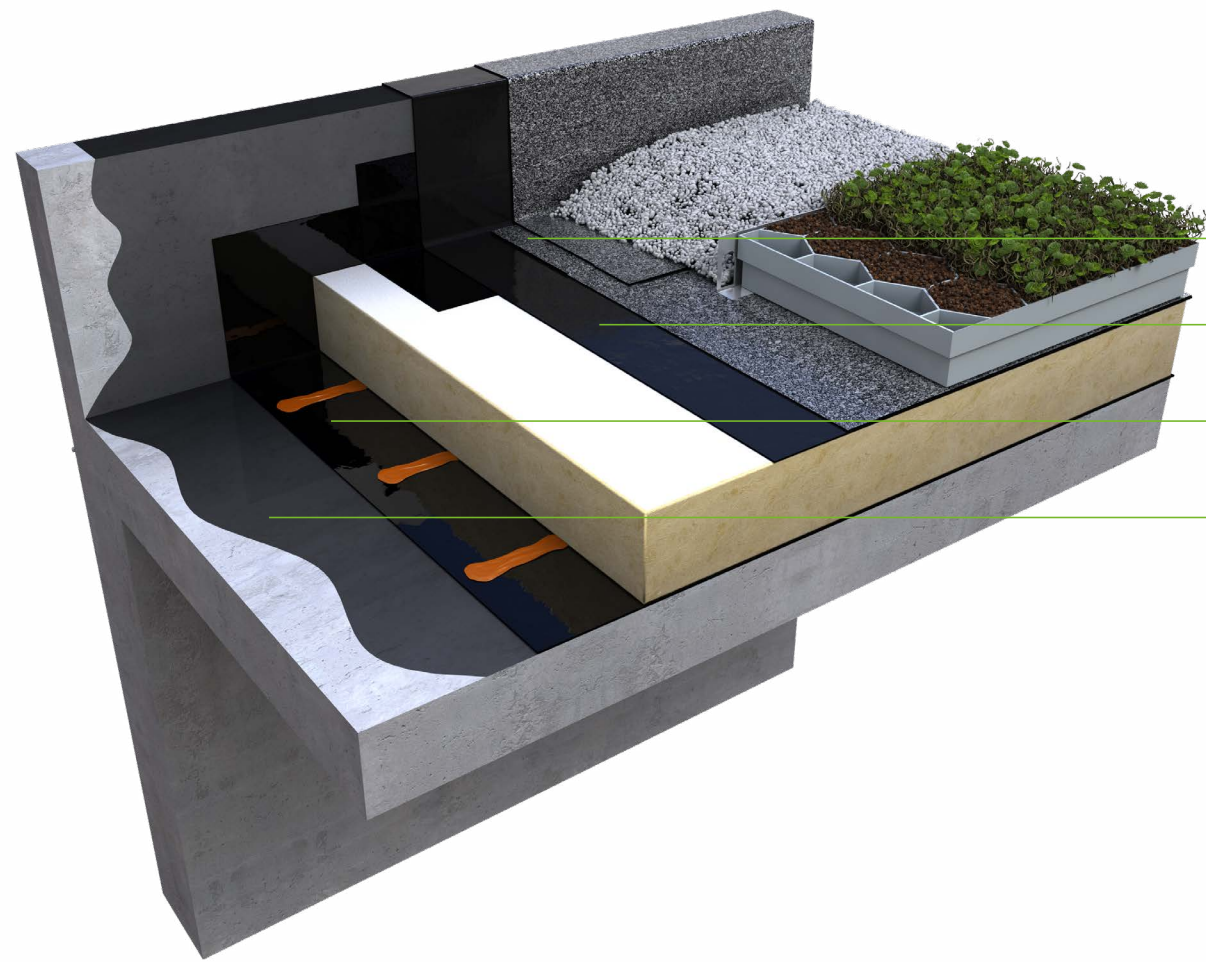

FORCE® 4000 TRAFIC

High performance SBS **multi-layer** waterproofing system

FORCE 4000 TRAFIC

FORCE LINE 3VV

FORCE LINE 3VV

BITUMEN BASED PRIMER



A BBA approved multi-layer green roof waterproofing system. FORCE® 4000 TRAFIC is approved for use under all green roof types and achieved a 25 year material system warranty as standard.

25 YEAR
WARRANTY



	10 YEAR	15 YEAR	20 YEAR	25 YEAR
TORCH ON MULTI LAYER WATERPROOFING SYSTEMS				
Capsheet	Force Line 3.5	Force Line 4.0	Force Line 4.5	Force Line 4.5
Details	Force Line 2VV + 3.5	Force Line 2VV + 4.0	Force Line 2VV + 4.5	Force Line 3VV + 4.5
Underlayer	Force Line 2VV	Force Line 2VV	Force Line 2VV	Force Line 3VV
AVCL	Force Line 2S or 2VV	Force Line 2S or 2VV	Force Line 2S or 2VV	Force Line 3VV
Primer	Bitumen Based Primer	Bitumen Based Primer	Bitumen Based Primer	Bitumen Based Primer
SELF ADHESIVE AND TORCH ON WATERPROOFING SYSTEMS				
Capheet	Force Line 3.5	Force Line 4.0	Force Line 4.5	Force Solo
Details	Force SA + 3.5	Force SA + 4	Force SA + 4.5	Force SA + Solo
Underlayer	Force SA	Force SA	Force 2SA	Force SA
AVCL	Force SA	Force SA	Force SA	Force SA
Primer	Bitumen Based Primer	Bitumen Based Primer	Bitumen Based Primer	Bitumen Based Primer

Force SA underlayer and self-adhesive AVCL should be used on combustible substrates

Aluminium cored AVCL available upon request to suite project requirements

	10 YEAR	15 YEAR	20 YEAR	25 YEAR
SINGLE LAYER WATERPROOFING SYSTEMS				
Capsheet				Force Solo
Details	N/A	N/A	N/A	Force Line 3VV + Solo
Primer				Bitumen Based Primer
GREEN ROOF MULTI LAYER WATERPROOFING SYSTEMS				
Capsheet		Force 4000 Trafic	Force 4000 Trafic	
Details		Force Line 2VV + 4000 Trafic	Force Line 3VV + 4000 Trafic	
Underlayer		Force Line 2VV	Force Line 3VV	
AVCL		Force Line 2VV	Force Line 3VV	
Primer		Bitumen Based Primer	Bitumen Based Primer	

N/A

FORCE LINE PRODUCT RANGE

PRODUCT NAME	surface finish	reinforcement (g/m²)	m² / roll	weight (kg)	rolls / pallet
TORCH ON CAPSHEETS					
FORCE LINE SBS¹	Mineral Granules	120 polyester	8	35	25
FORCE LINE 4.0²	Mineral Granules	150 polyester	8	40	25
FORCE LINE 4.5³	Mineral Granules	180 polyester	8	44	23
FORCE 4000 TRAFIC	Mineral Granules	250 polyester	8	41	20
SINGLE LAYER OVERLAY					
FORCE SOLO⁴	Mineral Granules	180 polyester	8	47	20
AVCL, UNDERLAYER, BASE LAYER					
FORCE LINE 2V	Film	50 Glass Fibre	16	48	23
FORCE LINE 3V	Sanded	50 Glass Fibre	10	42	25
FORCE LINE 2S	Sanded	50 Glass Fibre	16	50	22
FORCE SA*	Macroperferated Film & Sanded	50 Glass Fibre	16	40	25
PRIMER			coverage	volume	
BITUMEN BASED PRIMER	n/a	n/a	n/a	n/a	n/a

¹(Charcoal, Gris Ardennes, Natural Slate) ²(Red/Brown, Charcoal, Natural Slate) ³(Red/Brown, Charcoal, Natural Slate) ⁴(Charcoal) *self adhesive **depending on substrate

CLIENT WARRANTIES

are delivered on all FORCE® LINE system projects when materials are purchased via a recognised partner stockist. These warranties are long term and provide complete reassurance to the client.

FORCE® LINE systems have been developed to safeguard client and contractor confidence and ensure the delivery of high quality, durable and cost-effective roofing solutions that meet the demands of all projects. Long term Axter warranties covering materials and labour are available when using FORCE® LINE systems up to a market leading period of 25 years.



AXTERSIELD MEMBERSHIP

is exclusive to roofing contractors that demonstrate a consistent excellence in working practice over a wide range of roofing products and waterproofing disciplines.

The Axtershield accredited installer scheme provides unrivalled technical support, expert upskilling, unrestricted access to our exclusive system portfolio, project lead generation in both new build and refurbishment sectors and market leading guarantees.





Axter Ltd
Harbour Landing
Fox's Marina, Wherstead
Ipswich IP2 8NJ

01473 724056
www.axter.co.uk

