

1	FORCE® LINE under-layer
2	FORCE® LINE Capping Sheet
3	HYTHERM® tapered / flat board insulation fully bonded using Hyra-Stik adhesive (thickness to achieve design U-value and/or design fall)
4	FORCE® PRIME
5	FORCE® LINE air & vapour control layer (AVCL)
6	Timber hard edge/batten
7	FORCE® LINE to form welted drip detail
8	Lead apron flashing (by specialist subcontractor) (fixed in accordance to lead sheet Association Guide)
9	Batten tiles/slates (by specialist subcontractor)
10	Thermecran perforated layer
11	Concrete roof slab by specialist contractor

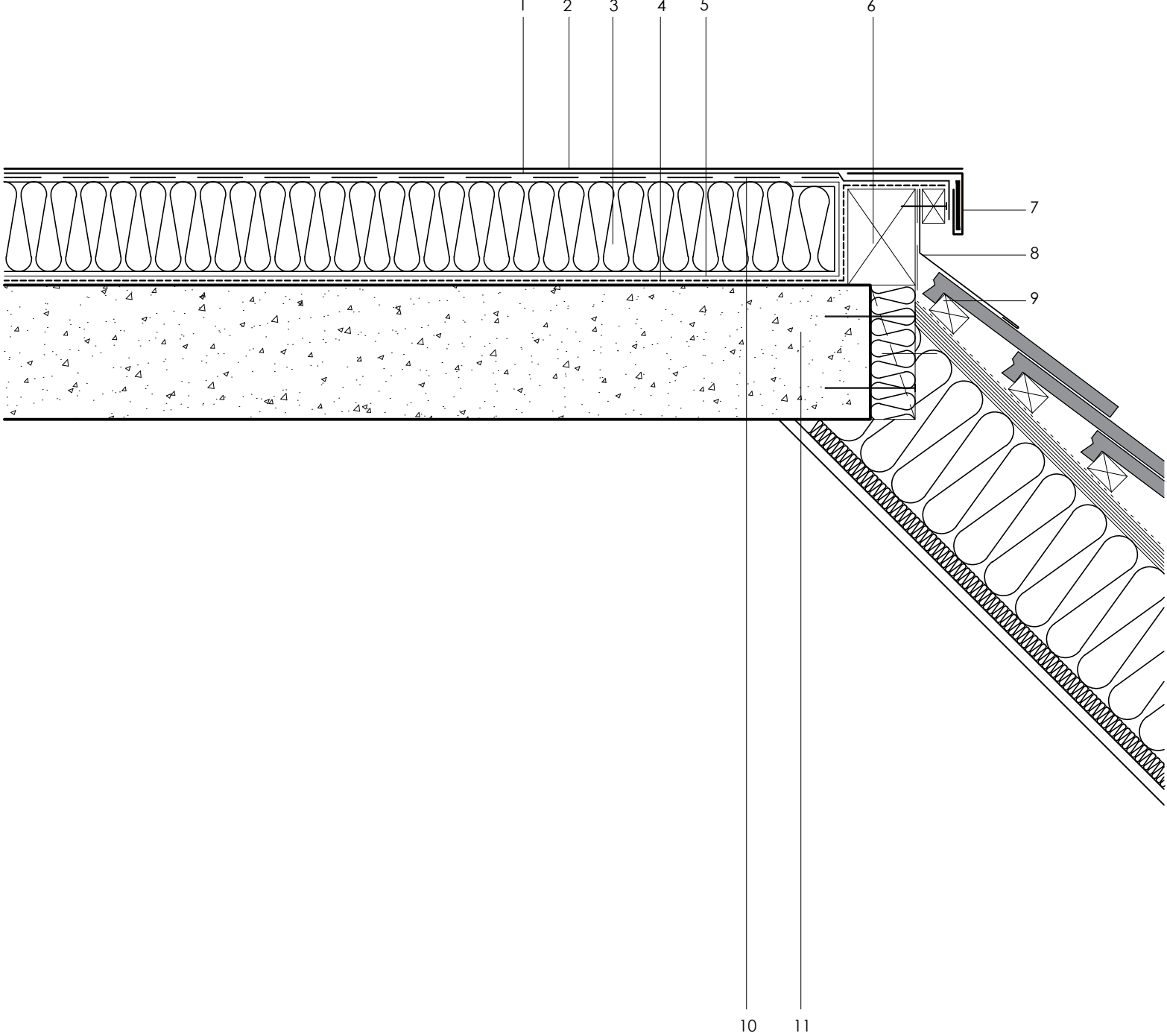

Axter provide detail drawings as part of our technical design service. Such drawings should only be used as a guide during the design process and should not be utilised during construction. Axter accepts no liability for misuse of this service.

PROJECT : N/A
CLIENT : N/A
DRAWING : FORCE® LINE TYPICAL MANSARD
EDGE DRIP DETAIL

DWG.No
WR.C.FL.120

SCALE
1:5 @ A4

DATE
2019

REV (if applicable)
N/A

STANDARD DETAIL